



- Note**
- 1) Grids Shown on this Map is based on the Magnetic North. Grid Values are Arbitrary. Easting +5000, Northing +3000
 - 2) All the Dimensions are in Meters unless otherwise mentioned.
 - 3) Levels are all Based on the Benchmark BM.891.564 Marked on the top of Manhole on 5th Cross Road.
 - 4) Total Area of the Site is as per the Boundary Shown & Instructions by Land Owner

Rev	Date	Description

- Legend**
- Boundary in Possession [Symbol]
 - Power Pole, Lamp Post [Symbol]
 - Road, Closed Drain [Symbol]
 - Stone, Transformer [Symbol]
 - Junction Box, Manhole [Symbol]
 - Benchmark, Gate [Symbol]
 - Contour with Annotation [Symbol]
 - Block Levels, Invert Levels [Symbol]
 - Trees: Coconut, Jack Fruit, Mango [Symbol]
 - Guava, Sapota, Sandlewood [Symbol]
 - Others [Symbol]

Area Statement

Position Area 01. Acre 25.16 Guntas
 or
 6,592.682 Sqmt / 70,963 Sqft

Worst case Area 01. Acre 24.71 Guntas

Client

Vajram Estates Private Limited

Title

TOPO MAP OF SY NO. 12/4
 KOGILU VILGE, YELAHNAKA HOBLI,
 YELAHNAKA TALUK, BANGALORE URBAN

Surveyed & Mapped By

ASIAN SURVEYS
 'Asian House', No. 19, G.F., 7th Cross, Ward No. 85
 Doddaneikundi Extension, Chinnagaganahalli, Bangalore-37
 Mob: 9972299777 / 9972178178

Drawing No. AS - 25576/2025 Season 23rd SEPTEMBER, 2025

Scale
 Cad Dwg 1 : 1
 Plot 1:500 or 1cm=5m

Drawn by Gnana Prakash Checked by G. Narayan

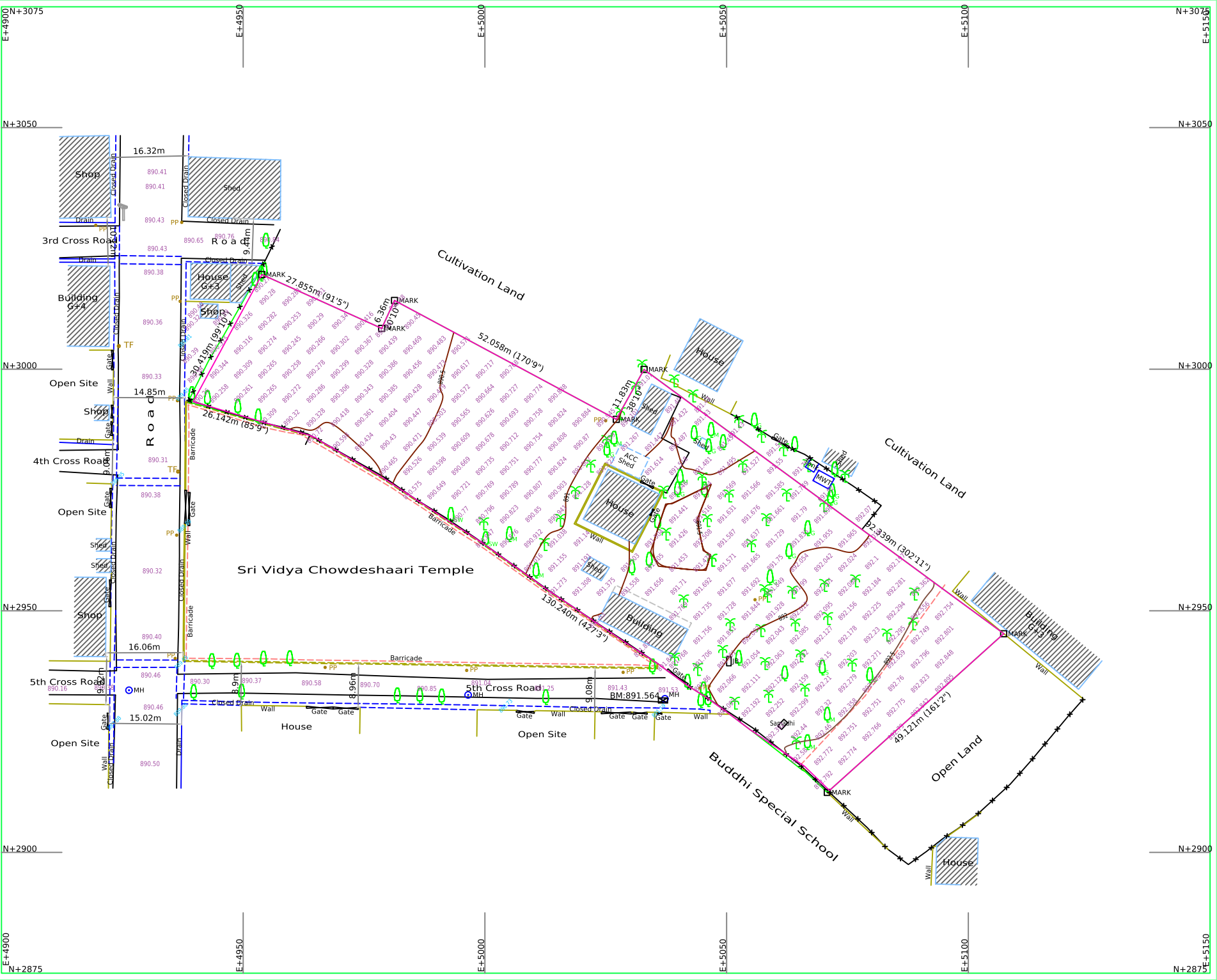

E+4900
N+2875

E+4950

E+5000

E+5050

E+5100
N+2900

E+5150
N+3075