



N+3050

N+3000

N+2950

N+2900

N+2875

N+3050

N+3000

N+2950

N+2900

N+2875

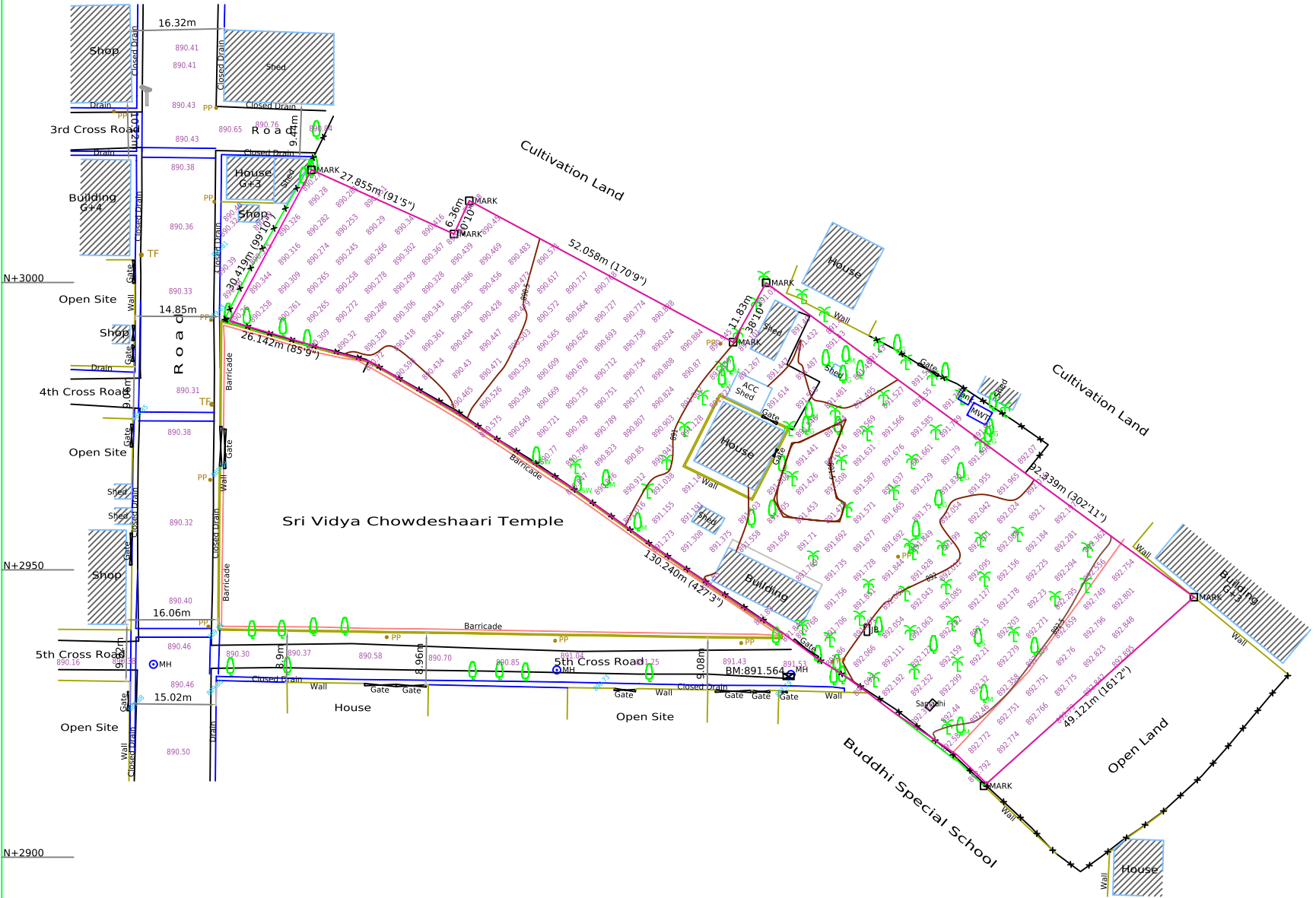

E+4900

E+4950

E+5000

E+5050

E+5100

E+4900

E+4950

E+5000

E+5050

E+5100

E+4900

E+4950

E+5000

E+5050

E+5100

E+5150

E+5150

Note

- 1) Grids Shown on this Map is based on the Magnetic North. Grid Values are Arbitrary. Easting +5000, Northing +3000
- 2) All the Dimensions are in Meters unless otherwise mentioned.
- 3) Levels are all Based on the Benchmark BM.891.564 Marked on the top of Manhole on 5th Cross Road.
- 4) Total Area of the Site is as per the Boundary Shown & Instructions by Land Owner

Legend

- Boundary in Possession
- Power Pole, Lamp Post
- Road, Closed Drain
- Stone, Transformer
- Junction Box, Manhole
- Benchmark, Gate
- Contour with Annotation
- Block Levels, Invert Levels
- Trees: Coconut, Jack Fruit, Mango
- Guava, Sapota, Sandlewood
- Others

Area Statement

Position Area01.Acre 25.16 Guntas
or
6,592.682 Sqmt / 70,963 Sqft
Worst case Area 01.Acre 24.71 Guntas

Client

Vajram Estates Private Limited

Title

TOPO MAP OF SY NO. 12/4
KOGILU VILGE, YELAHNAKA HOBLI,
YELAHNAKA TALUK, BANGALORE URBAN

Surveyed & Mapped By

ASIAN SURVEYS
"Asian House", No. 19, G.F, 7th Cross, Ward No. 85
Doddaneikundi Extension, Chinnaganahalli, Bangalore-37
Mob: 9972299777 / 9972178178

Drawing No. AS - 25576/2025 Season 23rd SEPTEMBER, 2025

Scale 1 : 1

Plot 1:500 or 1cm=5m

Drawn by Gnana Prakash Checked by G. Narayan