

**Note**

- 1) Grids Shown on this Map is based on the Magnetic North. Grid Values are Arbitrary Easting +5000, Northing +3000
- 2) All the Dimensions are in Meters unless otherwise mentioned.
- 3) Levels are all Based on the Benchmark BM.891.564 Marked on the top of Manhole on 5th Cross Road.
- 4) Total Area of the Site is as per the Boundary Shown & Instructions by Land Owner

Rev	Date	Description

**Legend**

- Boundary in Possession
- Power Pole, Lamp Post
- Road, Closed Drain
- Stone, Transformer
- Junction Box, Manhole
- Benchmark, Gate
- Contour with Annotation
- Block Levels, Invert Levels
- Trees: Coconut, Jack Fruit, Mango
- Guava, Sapota, Sandlewood
- Others

**Area Statement**

- Position Area .....01.Acre 25.16 Guntas or 6,592.682 Sqmt / 70,963 Sqft
- Worst case Area 01.Acre 24.71 Guntas

**Client**

Vajram Estates Private Limited

**Title**

TOPO MAP OF SY NO. 12/4  
KOGILU VILLEGE, YELAHNAKA HOBLI,  
YELAHNAKA TALUK, BANGALORE URBAN

**Surveyed & Mapped By**

ASIAN SURVEYS  
\*Asian House\*, No. 19, G.F., 7th Cross, Ward No. 85  
Doddanekundi Extension, Chinnaganahalli, Bangalore-37  
Mob: 9972299777 / 9972178178

**Drawing No.** AS - 25576/2025 **Season** 23rd SEPTEMBER, 2025

Scale	Cad Dwg	1 : 1
	Plot	1:500 or 1cm=5m

**Drawn by** Gnana Prakash **Checked by** G. Narayan

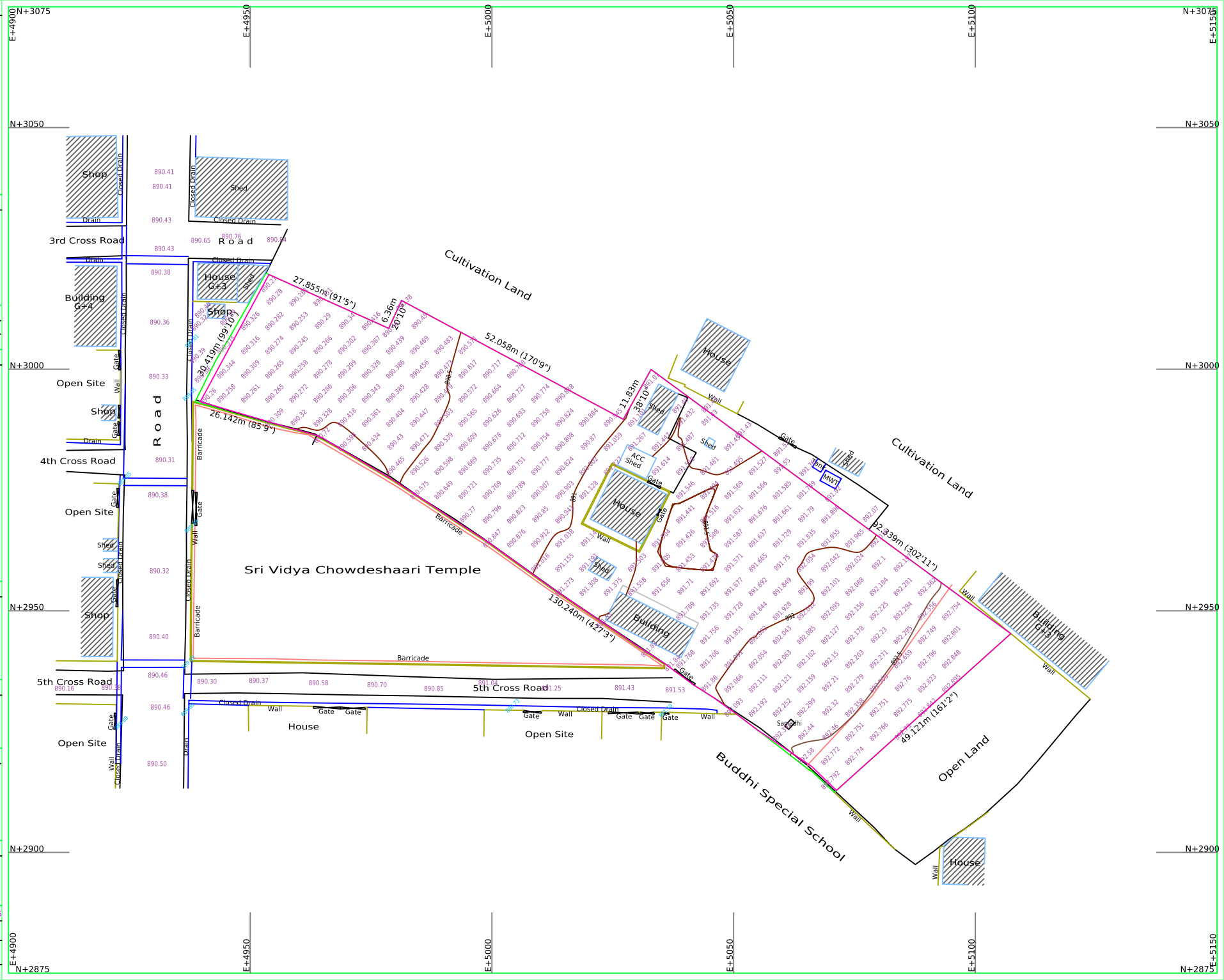

E+4900  
N+3075  
N+3050  
N+3000  
N+2950  
N+2900  
N+2875

E+4950

E+5000

E+5050

E+5100

E+5150  
N+3075  
N+3050  
N+3000  
N+2950  
N+2900  
N+2875